

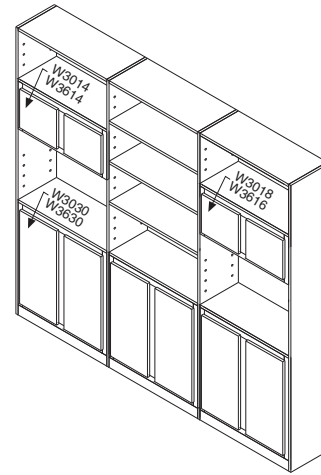

Wall System

- WSCP1384** Center Panel (1 per ctn.)
- WSEP1384** End Panels (2 per ctn.)
- WSS30** Wall System Shelves (2 per ctn.)
- WSS36** Wall System Shelves (2 per ctn.)
- WSS60** Wall System Shelves (2 per ctn.)
- WSTB30** Top/Bottom (2 per ctn.)
- WSTB36** Top/Bottom (2 per ctn.)

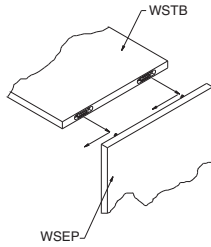

Panel	Description	Size (T x W x H)	Edge Finish	Color Side 1	Color Side 2	Finish
WSCP1384	Center Panel	3/4" x 13" x 84"	1 Long	Exterior	Exterior	Veneer
WSEP1384	End Panels	3/4" x 13" x 84"	1 Long	Exterior	Exterior	Veneer
WSS30	Wall System Shelves	3/4" x 13" x 30"	1 Long	Exterior	Exterior	Veneer
WSS36	Wall System Shelves	3/4" x 13" x 36"	1 Long	Exterior	Exterior	Veneer
WSS60	Wall System Shelves	3/4" x 13" x 60"	1 Long	Exterior	Exterior	Veneer
WSTB30	Top/Bottom	3/4" x 13" x 30"	1 Long	Exterior	Exterior	Veneer
WSTB36	Top/Bottom	3/4" x 13" x 36"	1 Long	Exterior	Exterior	Veneer

Book Shelf Kit

**BKSHELFKIT**

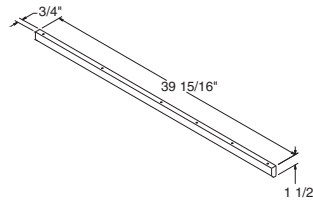

**NOTES** ✓

- ▶ Recommended for use with Bookcase units where loads on shelves will exceed over 60 lbs.
- ▶ One Shelf Kit required per shelf.
- ▶ Order under door style number.

## Appliance Centers

Under Wall Cabinet Accessory

- AC2417.5** Appliance Center, Diagonal
- ACS1817.5** Appliance Center, Straight
- ACS2417.5** Appliance Center, Straight
- ACS3017.5** Appliance Center, Straight

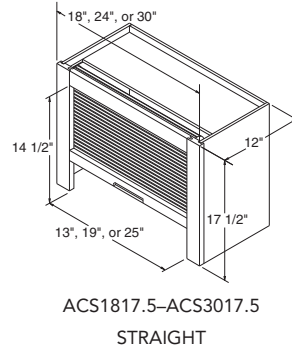
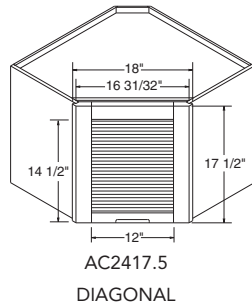

**NOTES** ✓

- ▶ AC2417.5 is designed to be used between countertop and Diagonal Wall cabinet.
- ▶ AC2417.5 opening – 12" W x 14.5" H.
- ▶ ACS1817.5 opening – 13" W x 14.5" H.
- ▶ ACS2417.5 opening – 19" W x 14.5" H.
- ▶ ACS3017.5 opening – 25" W x 14.5" H.

**DESIGN SOLUTIONS**

Work Zone 1 Food Storage.



## Stem Glass Holder

Under Wall Cabinet Accessory

- SGH30**
- SGH36**

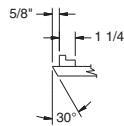
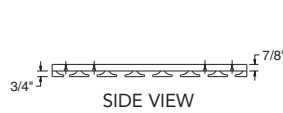
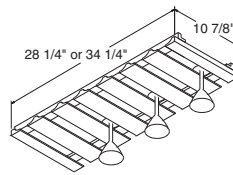

**NOTES** ✓

- ▶ Designed to be mounted underneath a standard Wall cabinet.
- ▶ SGH30 holds 7 rows.
- ▶ SGH36 holds 9 rows.



## Organizer Shelves

Under Wall Cabinet Accessory

- ORG24**

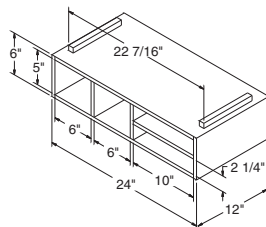

- ORG30**

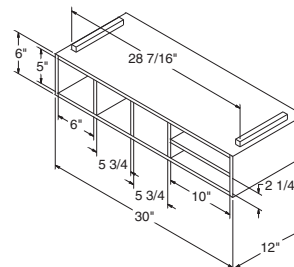

**NOTES** ✓

- ▶ Designed to mount underneath wall cabinet.
- ▶ Top, bottom, and sides are finished.



**NOTES** ✓

- ▶ Designed to mount underneath wall cabinet.
- ▶ Top, bottom, and sides are finished.



## Organizer Shelves (continued)

Under Wall Cabinet Accessory

**ORG36**

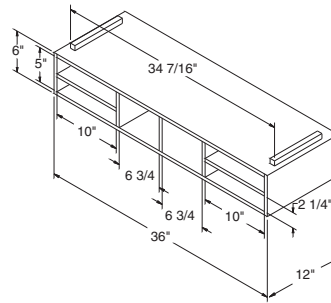

**NOTES** ✓

- ▶ One 3/4" thick matching Aristex® shelf mounted to each Stem Glass Holder.
- ▶ Stem Glass Holder is installed by placing shelf in position with included shelf clips.
- ▶ SGH18 fits 18" wide wall cabinets.
- ▶ SGH21 fits 21" wide wall cabinets.



## Stem Glass Holder

Wall Open Cabinet Accessory

**SGH18**  
**SGH21**

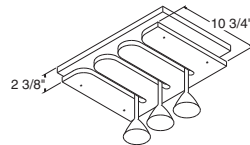

**NOTES** ✓

- ▶ One 3/4" notched matching Aristex® shelf and four clips included.
- ▶ Wine Caddy rests on shelf and shelf can be adjusted to desired position.
- ▶ WC18 holds three bottles. Fits 18" wide wall cabinets.
- ▶ WC21 holds four bottles. Fits 21" wide wall cabinets.



## Wine Caddy

Wall Open Cabinet Accessory

**WC18**  
**WC21**

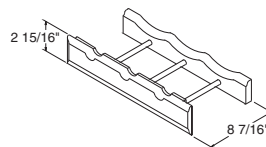

## Apothecary Drawer

Wall Open Cabinet Accessory

**APDWR18**  
**APDWR21**

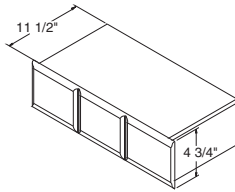

**NOTES** ✓

- ▶ Will only mount inside of Open Wall cabinets. Cannot be used underneath cabinets.
- ▶ Apothecary Drawer is mounted in a 1/2" standard laminated case (natural maple color), and comes complete with side-mounted Full-Extension drawer guide system.
- ▶ One 3/4" notched matching Aristex® shelf included with each Apothecary Drawer to place on top of case to give it a finished look.
- ▶ Units have a simulated three-panel drawer front except Augusta, Durham, and Ellsworth. Augusta and Ellsworth drawer fronts are slab and Durham drawer front is 5-piece.
- ▶ Does not include decorative hardware on any style.
- ▶ Only available in Standard construction (not available as wood dovetail).
- ▶ Order by door style number, not common style number.
- ▶ APDWR18 fits 18" wide Wall cabinet.
- ▶ APDWR21 fits 21" wide Wall cabinet.

## Plate Racks

Wall Open Cabinet Accessory

**PR18**  
**PR21**

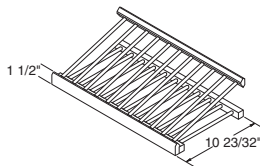

**NOTES** ✓

- ▶ Designed for use in WOL cabinets.
- ▶ PR18 fits 18" wide Wall cabinet. Holds 8 plates.
- ▶ PR21 fits 21" wide Wall cabinet. Holds 10 plates.
- ▶ Can be easily removed for cleaning.



**NOTES** ✓

- ▶ Natural wood finish with chrome bars.
- ▶ Designed for Wall cabinets (30", 36", and 42" high), Base cabinets, Utility cabinets, and Linen Closet cabinets. Make sure to avoid interference with roll trays, full depth shelves, or other interior cabinet accessories.
- ▶ Mounts to door frame.
- ▶ Order under style #010.

**DESIGN SOLUTIONS**

- ▶ Great for use in the bathroom to hold vitamins, medications, etc.

## Wall Spice Racks

Wall Cabinet Accessory

- SRD15** Spice Rack, Door Mounted (21 1/4" H x 9 1/2" W)
- SRD18** Spice Rack, Door Mounted (21 1/4" H x 12 1/2" W)
- SRD21** Spice Rack, Door Mounted (21 1/4" H x 15 1/2" W)

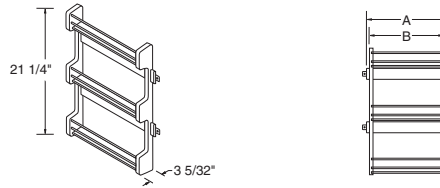

	Recommended for
SRD15	15" or 30" wide
SRD18	18" or 36" wide
SRD21	21" or 42" wide

	A dimension	B dimension
SRD15	10 1/2"	9 1/2"
SRD18	13 1/2"	12 1/2"
SRD21	16 1/2"	15 1/2"

**NOTES** ✓

- ▶ Pegged board is 3/8" thick.
- ▶ Recommended for use in LRB36. Pegged board can be trimmed for use in smaller applications.
- ▶ PDO includes 8 wooden posts and board.
- ▶ PDOPOSTS includes 4 wooden posts.
- ▶ Order under style #010.

**DESIGN SOLUTIONS**

Work Zone 4 Cleanup.



## Pegged Dish Organizer

Drawer Accessory

**PDO**  
**PDOPOSTS**

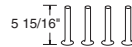
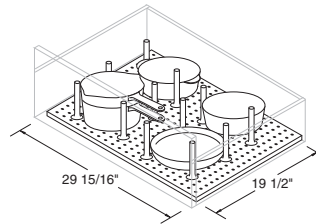

**NOTES** ✓

- ▶ White plastic tiered rack with notches to help keep spices from rolling.
- ▶ Depth is 19 15/16" to fit a dovetail drawer and can be easily trimmed with no cutting to 18 15/16" to fit a furniture board drawer.
- ▶ Order under style #010.

## Drawer Spice Racks

Drawer Accessory

- SR12**
- SR15**
- SR18**
- SR21**
- SR24**

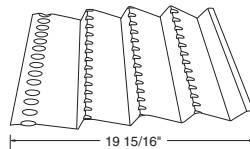

## Bread Lid Kits

Drawer Accessory

- BLK15** Bread Lid Kit
- BLK18** Bread Lid Kit
- BLK21** Bread Lid Kit
- BLK24** Bread Lid Kit
- UMBLK15C** Undermount Bread Lid Kit (for 3/4" Dovetail Drawer)
- UMBLK18C** Undermount Bread Lid Kit (for 3/4" Dovetail Drawer)
- UMBLK21C** Undermount Bread Lid Kit (for 3/4" Dovetail Drawer)
- UMBLK24C** Undermount Bread Lid Kit (for 3/4" Dovetail Drawer)

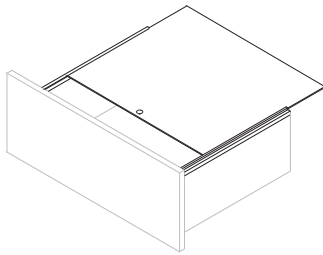

**NOTES** ✓

- ▶ Acrylic Bread Lid Kit.
- ▶ Drawer not included.
- ▶ Order under style #010.
- ▶ BLK units are for standard drawer boxes.
- ▶ UMBLK units are for dovetail drawer boxes.

## Cutlery Trays

Drawer Accessory

- CT15** Cutlery Tray 15", Plastic
- CT15UM** Cutlery Tray 15", Plastic
- CT18** Cutlery Tray 18", Plastic
- CT18UM** Cutlery Tray 18", Plastic
- CT21** Cutlery Tray 21", Plastic
- CT21UM** Cutlery Tray 21", Plastic
- CT24** Cutlery Tray 24", Plastic
- CT24UM** Cutlery Tray 24", Plastic

	Width	Depth
CT15	9 27/32"	18 15/16"
CT15UM	9 15/16"	19 15/16"
CT18	12 27/32"	18 15/16"
CT18UM	12 15/16"	19 15/16"
CT21	15 27/32"	18 15/16"
CT21UM	15 15/16"	19 15/16"
CT24	18 27/32"	18 15/16"
CT24UM	18 15/16"	19 15/16"

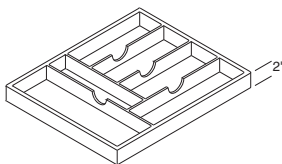

**NOTES** ✓

- ▶ Cutlery Trays are standard on drawer Base cabinets 15"-24" wide.
- ▶ All Cutlery Trays are white and 2" high.
- ▶ CT \_\_ depth is 18 15/16" (for 20" deep furniture board drawers).
- ▶ CT \_\_ UM depth is 19 15/16" (for 21" deep undermount dovetail drawers).
- ▶ Order under style #010.

**DESIGN SOLUTIONS**

Work Zone **2** Preparation.

**NOTES** ✓

- ▶ CBK contains Cutlery Drawer, drawer front, drawer frame assembly, and Cutting Board.
- ▶ CBK can be field installed for B18, B36, and DB18.
- ▶ Order under door style number.

**DESIGN SOLUTIONS**

Work Zone **2** Preparation.

## Cutting Board Kit

Drawer Accessory

**CBK**

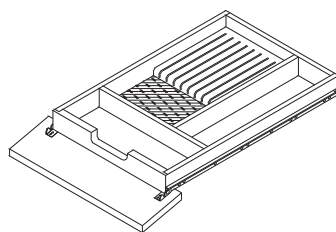

CUTLERY KIT

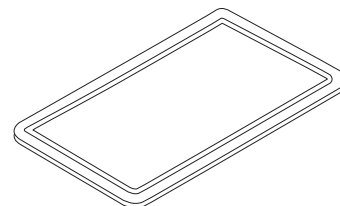

CUTTING BOARD

**NOTES** ✓

- ▶ Cabinet not included. Must be ordered separately.
- ▶ Not available in Nantucket or Augusta.
- ▶ Order Teagan doors as Winstead.
- ▶ Durham is only available in WPG sizes.
- ▶ Glass is not included.
- ▶ Not available on Utility and LCD cabinet tall doors.
- ▶ Doors prepared for insert by customer.

## Doors Cut For Glass

**DCFG**

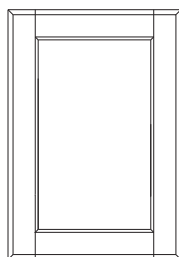

**NOTES** ✓

- ▶ Meets KCMA standards of 15 lbs. per square foot.
- ▶ Cannot be trimmed.
- ▶ Kit includes two 1/4" thick tempered glass shelves and shelf clips.
- ▶ Order under style #010.

## Glass Shelf Kit, 12" Deep

- GSK1512**
- GSK1812**
- GSK2112**
- GSK2412**
- GSK2712**
- GSK3012**
- GSK3312**
- GSK3612**

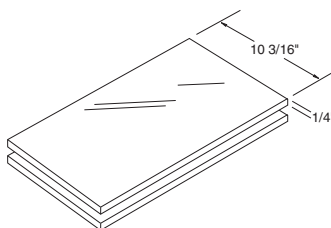

## Glass Shelf Kit, Diagonal

**GSKDC24**  
**GSKDC27**

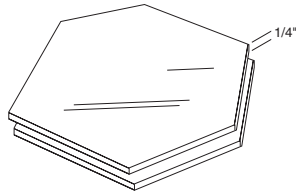

GSKDC24 (FITS DC...24)

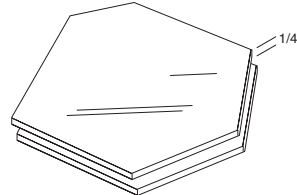

GSKDC27 (FITS DC...27)

**NOTES** ✓

- ▶ Meets KCMA standards of 15 lbs. per square foot.
- ▶ Cannot be trimmed.
- ▶ Kit includes two 1/4" thick tempered glass shelves and shelf clips.
- ▶ Order under style #010.

## Oven Installation Kit

**OCINSTALLKIT**

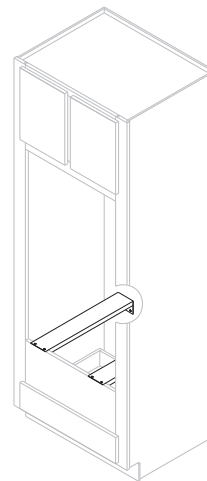
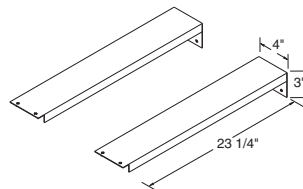

**NOTES** ✓

- ▶ Two metal brackets to support ovens and microwaves.
- ▶ Designed to be used with OC and OCD cabinets.
- ▶ Cabinet not included.
- ▶ Order under style #010.

**NOTES** ✓

- ▶ Pantry Shelf Kits contain four shelves and sixteen clips.
- ▶ Maximum weight per square foot is 15 lbs.
- ▶ Pantry Shelf Kits are natural maple laminate or specify PKS\_ \_WH for white.
- ▶ Order under style #010.

## Pantry Shelf Kits

### 1/2" Thick

**PKS15**

Pantry Shelf Kit (13 1/2" x 22 1/2"-1/2" thick, natural maple laminate, fits 24" deep)

**PKS15WH**

Pantry Shelf Kit (13 1/2" x 22 1/2"-1/2" thick, white laminate, fits 24" deep)

**PKS18**

Pantry Shelf Kit (16 1/2" x 22 1/2"-1/2" thick, natural maple laminate, fits 24" deep)

**PKS18WH**

Pantry Shelf Kit (16 1/2" x 22 1/2"-1/2" thick, white laminate, fits 24" deep)

**PKS24**

Pantry Shelf Kit (22 1/2" x 22 1/2"-1/2" thick, natural maple laminate, fits 24" deep)

**PKS24WH**

Pantry Shelf Kit (22 1/2" x 22 1/2"-1/2" thick, white laminate, fits 24" deep)

**PKS1512**

Pantry Shelf Kit (13 1/2" x 10 11/32"-1/2" thick, natural maple laminate, fits 12" deep)

**PKS1512WH**

Pantry Shelf Kit (13 1/2" x 10 11/32"-1/2" thick, white laminate, fits 12" deep)

**PKS1812**

Pantry Shelf Kit (16 1/2" x 10 11/32"-1/2" thick, natural maple laminate, fits 12" deep)

**PKS1812WH**

Pantry Shelf Kit (16 1/2" x 10 11/32"-1/2" thick, white laminate, fits 12" deep)

**PKS2412**

Pantry Shelf Kit (22 1/2" x 10 11/32"-1/2" thick, natural maple laminate, fits 12" deep)

**PKS2412WH**

Pantry Shelf Kit (22 1/2" x 10 11/32"-1/2" thick, white laminate, fits 12" deep)

### 3/4" Thick

**PKS15C**

Pantry Shelf Kit (13 1/2" x 22 1/2"-3/4" thick, natural maple laminate, fits 24" deep)

**PKS15CWH**

Pantry Shelf Kit (13 1/2" x 22 1/2"-3/4" thick, white laminate, fits 24" deep)

**PKS18C**

Pantry Shelf Kit (16 1/2" x 22 1/2"-3/4" thick, natural maple laminate, fits 24" deep)

**PKS18CWH**

Pantry Shelf Kit (16 1/2" x 22 1/2"-3/4" thick, white laminate, fits 24" deep)

**PKS24C**

Pantry Shelf Kit (22 1/2" x 22 1/2"-3/4" thick, natural maple laminate, fits 24" deep)

**PKS24CWH**

Pantry Shelf Kit (22 1/2" x 22 1/2"-3/4" thick, white laminate, fits 24" deep)

**PKS30C**

Pantry Shelf Kit (28 1/2" x 22 1/2"-3/4" thick, natural maple laminate, fits 24" deep)

**PKS30CWH**

Pantry Shelf Kit (28 1/2" x 22 1/2"-3/4" thick, white laminate, fits 24" deep)

**PKS36C**

Pantry Shelf Kit (34 1/2" x 22 1/2"-3/4" thick, natural maple laminate, fits 24" deep)

**PKS36CWH**

Pantry Shelf Kit (34 1/2" x 22 1/2"-3/4" thick, white laminate, fits 24" deep)

**PKS1512C**

Pantry Shelf Kit (13 1/2" x 10 11/32"-3/4" thick, natural maple laminate, fits 12" deep)

**PKS1512CWH**

Pantry Shelf Kit (13 1/2" x 10 11/32"-3/4" thick, white laminate, fits 12" deep)

**PKS1812C**

Pantry Shelf Kit (16 1/2" x 10 11/32"-3/4" thick, natural maple laminate, fits 12" deep)

**PKS1812CWH**

Pantry Shelf Kit (16 1/2" x 10 11/32"-3/4" thick, white laminate, fits 12" deep)

**PKS2412C**

Pantry Shelf Kit (22 1/2" x 10 11/32"-3/4" thick, natural maple laminate, fits 12" deep)

**PKS2412CWH**

Pantry Shelf Kit (22 1/2" x 10 11/32"-3/4" thick, white laminate, fits 12" deep)

**PKS3012C**

Pantry Shelf Kit (28 1/2" x 10 11/32"-3/4" thick, natural maple laminate, fits 12" deep)

**PKS3012CWH**

Pantry Shelf Kit (28 1/2" x 10 11/32"-3/4" thick, white laminate, fits 12" deep)

**PKS3612C**

Pantry Shelf Kit (34 1/2" x 10 11/32"-3/4" thick, natural maple laminate, fits 12" deep)

**PKS3612CWH**

Pantry Shelf Kit (34 1/2" x 10 11/32"-3/4" thick, white laminate, fits 12" deep)

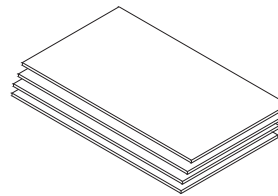
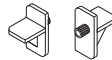

## Pantry Roll Out Kits

<b>UPK15</b>	Pantry Roll Out Kit 15" (10 11/16" W x 20 3/16" D x 3 1/8" H)
<b>UPK15WH</b>	Pantry Roll Out Kit 15" (10 11/16" W x 20 3/16" D x 3 1/8" H)
<b>UPK18</b>	Pantry Roll Out Kit 18" (13 11/16" W x 20 3/16" D x 3 1/8" H)
<b>UPK18WH</b>	Pantry Roll Out Kit 18" (13 11/16" W x 20 3/16" D x 3 1/8" H)
<b>UPK24</b>	Pantry Roll Out Kit 24" (19 11/16" W x 20 3/16" D x 3 1/8" H)
<b>UPK24WH</b>	Pantry Roll Out Kit 24" (19 11/16" W x 20 3/16" D x 3 1/8" H)
<b>UPK30</b>	Pantry Roll Out Kit 30" (25 11/16" W x 20 3/16" D x 3 1/8" H)
<b>UPK30WH</b>	Pantry Roll Out Kit 30" (25 11/16" W x 20 3/16" D x 3 1/8" H)
<b>UPK36</b>	Pantry Roll Out Kit 36" (31 11/16" W x 20 3/16" D x 3 1/8" H)
<b>UPK36WH</b>	Pantry Roll Out Kit 36" (31 11/16" W x 20 3/16" D x 3 1/8" H)

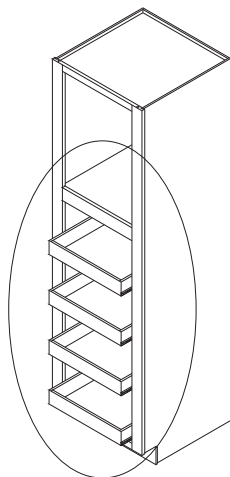

### NOTES ✓

- ▶ Pantry Roll Out Kits contain four trays, eight suspension tracks, four corner standards, and installation screws.
- ▶ Maximum weight per square foot is 15 lbs.
- ▶ Pantry Roll Out Trays cannot be used in any Utility cabinet 12" deep.
- ▶ Pantry Roll Out Kits are natural maple laminate or specify UPK\_ \_WH for white.
- ▶ Order under style #010.

### DESIGN SOLUTIONS

Work Zone **1** Food Storage.

- ▶ Shelf or Roll Out Tray Kits can be used to convert a standard Utility cabinet into a Pantry.

## Roll Out Kits

<b>TKIT15</b>	Roll Out Tray Kit (fits 12" opening) Fits B15, B30, SB30, B15FH, & B30FH
<b>TKIT15WH</b>	Roll Out Tray Kit (fits 12" opening) Fits B15, B30, SB30, B15FH, & B30FH
<b>TKIT18</b>	Roll Out Tray Kit (fits 15" opening) Fits B18, B36, SB36, B18FH, & B36FH
<b>TKIT18WH</b>	Roll Out Tray Kit (fits 15" opening) Fits B18, B36, SB36, B18FH, & B36FH
<b>TKIT21</b>	Roll Out Tray Kit (fits 18" opening) Fits B21, B42, SCB48, SB42, B21FH, & B42FH
<b>TKIT21WH</b>	Roll Out Tray Kit (fits 18" opening) Fits B21, B42, SCB48, SB42, B21FH, & B42FH
<b>TKIT24</b>	Roll Out Tray Kit (fits 21" opening) Fits B24, B48, SB24, SB48, B24DD, B24DDRT, & B24FH
<b>TKIT24WH</b>	Roll Out Tray Kit (fits 21" opening) Fits B24, B48, SB24, SB48, B24DD, B24DDRT, & B24FH
<b>TKIT27</b>	Roll Out Tray Kit 27" (fits 24" opening) Fits B27RT
<b>TKIT27WH</b>	Roll Out Tray Kit 27" (fits 24" opening) Fits B27RT
<b>TKIT30</b>	Roll Out Tray Kit 30" (fits 27" opening) Fits B30RT
<b>TKIT30WH</b>	Roll Out Tray Kit 30" (fits 27" opening) Fits B30RT
<b>TKIT33</b>	Roll Out Tray Kit 33" (fits 30" opening) Fits B33RT
<b>TKIT33WH</b>	Roll Out Tray Kit 33" (fits 30" opening) Fits B33RT
<b>TKIT36</b>	Roll Out Tray Kit 36" (fits 33" opening) Fits B36RT
<b>TKIT36WH</b>	Roll Out Tray Kit 36" (fits 33" opening) Fits B36RT
<b>TKIT39</b>	Roll Out Tray Kit 39" (fits 16 1/2" opening) Fits B39RT
<b>TKIT39WH</b>	Roll Out Tray Kit 39" (fits 16 1/2" opening) Fits B39RT
<b>TKIT45</b>	Roll Out Tray Kit 45" (fits 19 1/2" opening) Fits B45RT
<b>TKIT45WH</b>	Roll Out Tray Kit 45" (fits 19 1/2" opening) Fits B45RT

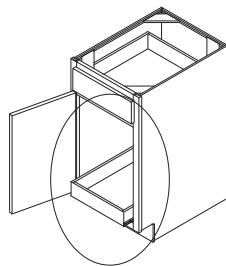

### NOTES ✓

- ▶ Roll Out Tray Kit contains: 1 tray, 2 track slides, 2 mounting blocks, two 2 1/2" wood screws, four 5/8" wood screws, and two 1/8" spacers.
- ▶ Hardwood front, furniture board back, sides, and bottom or specify TKIT\_ \_WH for white.
- ▶ Max. weight per sq. ft.–15 lbs.
- ▶ All guides are white.
- ▶ Order under style #010.
- ▶ No TKIT available for B27 due to face frame.
- ▶ TKIT39/TKIT39WH & TKIT45/TKIT45WH Contain: 2 trays, 4 track slides, 4 mounting blocks, two 2 1/2" wood screws, eight 5/8" wood screws, and two 1/8" spacers.

### DESIGN SOLUTIONS

- ▶ An additional Roll Out Tray can be installed above the Base cabinet half-depth shelf.

**NOTES** ✓

- ▶ Includes two bumpers, two screws.
- ▶ Use to protect door from Roll Tray corner.
- ▶ Order under style #010.

## Roll Tray Bumper Pads

**RTBP**

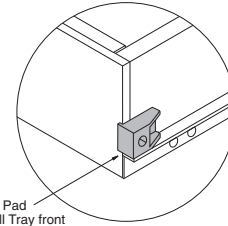
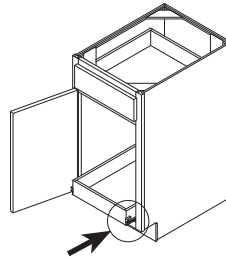

Place Bumper Pad on edge of Roll Tray front on top of Roll Tray Slide.

**NOTES** ✓

- ▶ Overall dimensions: 12 1/16" W x 22 1/2" D x 18 3/4" H (fits 15" wide Base cabinet).
- ▶ White epoxy coated wire with Full Extension guides.
- ▶ Includes two 27 quart Wastebaskets with wire storage compartment.
- ▶ Mounted on white melamine board and installs to floor of cabinet.
- ▶ Order under style #010.

★ Installation of this accessory requires removing half-depth shelf from Base cabinet. See matrix on page 170 for installation recommendations.

**DESIGN SOLUTIONS**

Work Zone **4** Cleanup.

## Double Wastebasket Roll Out

**DWBR ★**

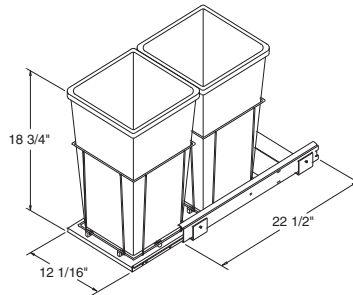

## Sink Tip-Out Trays

**NOTES** ✓

- ▶ Pulls to add to the false front must be ordered separately.
- ▶ If STOTs are used on a full overlay style, it is recommended that a Pull be used. See matrix on page 170 for installation recommendations.
- ▶ 2 1/4" deep.
- ▶ Order under style #010.

**STOT30WH**  
**STOT36WH**

Sink (tip-out) Tray 30" (2 - 11½" trays) White  
Sink (tip-out) Tray 36" (2 - 14½" trays) White

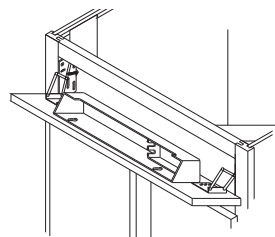

Smart Stop Door Mechanism

**SSDM**

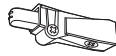

**NOTES** ✓

- ▶ Creates a smooth and silent closing motion.
- ▶ Recommended usage per cabinet: 1 per door on any door with 2 hinges and 2 per door on any door with 3 or more hinges. Additional units may be required when an accessory item is attached to the cabinet door.
- ▶ Not recommended for use on bi-fold doors or Base SuperCabinets™.

Hinges

**HINGE  
ADJHINGE**

Stain, Toner, and Touch-Up

- STAINPT** Pint of Stain
- STAINQT** Quart of Stain
- TONERPT** Pint of Toner
- TUKIT \*** Touch-Up Kit
- TUPSTICK \*\*** Touch-Up Stick
- TUPSPRAY** Touch-Up Spray Can

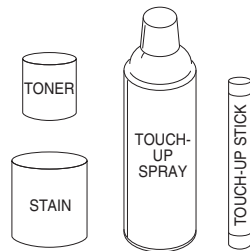

**NOTES** ✓

- ▶ Order 1 pint of Toner for 1 quart of Stain.
- ▶ For white and antique styles, Touch-Up is only recommended for face frames and End Panels.
- ★ Touch-Up Kit contains one felt marker and one putty stick.
- ★★ Touch-Up Stick – when ordering TUPSTICK, a single putty stick in the selected color is sent.
- † Wheat stain for Oak, Hickory, and Cherry will be the same.

Wood Type	Color	Style #	Toner	Stain/Glaze
Oak	Natural	•	–	–
Oak	Wheat†	186	–	Wheat
Oak	Spice	185	Spice	Spice
Oak	Saddle	171	Saddle	Saddle
Maple/Birch	Fawn	197	Fawn	–
Maple/Birch	Autumn	183	Autumn	Autumn
Maple	Natural	182	Natural	–
Maple/Birch	Rouge	180	Rouge	Rouge
Maple	Cocoa	179	Glaze Toner	Cocoa Glaze
Maple	Saddle	170	Saddle	Saddle
Maple	Java	168	Glaze Toner	Java Glaze
Maple	Harvest	166	Glaze Toner	Harvest Glaze
Thermofoil	White	•	–	–
Thermofoil	Antique	•	–	–
DLV	Toasted Antique	•	–	–
Hickory	Natural	•	–	–
Hickory	Wheat†	177	–	Wheat
Hickory	Saddle	172	Saddle	Saddle
Cherry	Cognac	195	Cognac	Cognac
Cherry	Wheat†	176	–	Wheat
Cherry	Cocoa	175	Glaze Toner	Cocoa Glaze
Cherry	Rouge	174	Rouge	Rouge
Cherry	Saddle	173	Saddle	Saddle
Cherry	Java	169	Glaze Toner	Java Glaze

TRADITIONAL STORAGE ACCESSORY MATRIX							
Cabinet	Double Wastebasket Roll Out	Sink Tip-Out Tray 30"	Sink Tip-Out Tray 36"	Cabinet	Double Wastebasket Roll Out	Sink Tip-Out Tray 30"	Sink Tip-Out Tray 36"
B12	•	•	•	SF36	P	*	•
B15	H *	•	•	SF42	P		*
B18	H	•	•	SF48	P		
B21	H	•	•	SFC36	P		•
B24	H	•	•	SFC42	P		
B24DD	H	•	•	PB18	F	•	•
B27	•	•	•	PB24	F	•	•
B30	H *	•	•	PB30	F	•	•
B33	H	•	•	PB36	F	•	•
B36	H	•	•	PB42	F	•	•
B39	H	•	•	PB48	F	•	•
B42	H	•	•	PBSC27	F	•	•
B48	H	•	•	PBSC42	F	•	•
B15FH	*	•	•	PBSC48	F	•	•
B18FH	*	•	•	U18		•	•
B21FH	*	•	•	U24		•	•
B24FH	*	•	•	U1812	•	•	•
B30FH	*	•	•	U2412	•	•	•
B36FH	*	•	•	U1896		•	•
BWB18	•	•	•	U2496		•	•
SCB36	•	•	•	U189612	•	•	•
SCB39	H	•	•	U249612	•	•	•
SCB42	H	•	•	U1890		•	•
SCB45	H	•	•	U2490		•	•
SCB48	H	•	•	U189012	•	•	•
SCER36	•	•	•	U249012	•	•	•
SB24	P			B24DDFHU		•	•
SB27	P	•	†	B30FHU		•	•
SB30	P	*	•	B33FHU		•	•
SB33	P		•	B36FHU		•	•
SB36	P		*	SB30UD	•	*	•
SB39	P			SB36UD	•		*
SB42	P			U18UD		•	•
SB48	P			U24UD		•	•
SF30	P						

**NOTES** ✓

**Key**

- F** Must remove full-depth shelf.
- H** Must remove half-depth shelf.
- I** Can be installed without modification to cabinet.
- P** Location of plumbing should be checked prior to installation of storage accessory.
- \*** Recommended.
- Not applicable.
- †** Only one tray will fit.

**GLASS SIZE CHART FOR WALL PREPPED FOR GLASS CABINETS**

	Durham Eastland Sutherland Wentworth		Ellsworth Roxburgh Winstead		Kincaid Manchester Saybrooke		Grayson Landen		Avalon Oakland Pioneer Radford Sinclair Westbury	
	Width	Height	Width	Height	Width	Height	Width	Height	Width	Height
<b>RECOMMENDED GLASS SIZES</b>										
WPG1542	9 5/8"	36 5/8"	10 13/16"	37 13/16"	9 1/4"	36 1/4"	8 1/8"	35 1/8"	9 5/8"	36 5/8"
WPG3042	9 5/8"	36 5/8"	10 13/16"	37 13/16"	9 1/4"	36 1/4"	8 1/8"	35 1/8"	9 5/8"	36 5/8"
WPG1842	12 5/8"	36 5/8"	13 13/16"	37 13/16"	12 1/4"	36 1/4"	11 1/8"	35 1/8"	12 5/8"	36 5/8"
WPG3642	12 5/8"	36 5/8"	13 13/16"	37 13/16"	12 1/4"	36 1/4"	11 1/8"	35 1/8"	12 5/8"	36 5/8"
WPG2142	15 5/8"	36 5/8"	16 13/16"	37 13/16"	15 1/4"	36 1/4"	14 1/8"	35 1/8"	15 5/8"	36 5/8"
WPG2442	18 5/8"	36 5/8"	19 13/16"	37 13/16"	18 1/4"	36 1/4"	17 1/8"	35 1/8"	18 5/8"	36 5/8"
WPG1536	9 5/8"	30 5/8"	10 13/16"	31 13/16"	9 1/4"	30 1/4"	8 1/8"	29 1/8"	9 5/8"	30 5/8"
WPG3036	9 5/8"	30 5/8"	10 13/16"	31 13/16"	9 1/4"	30 1/4"	8 1/8"	29 1/8"	9 5/8"	30 5/8"
WPG1836	12 5/8"	30 5/8"	13 13/16"	31 13/16"	12 1/4"	30 1/4"	11 1/8"	29 1/8"	12 5/8"	30 5/8"
WPG3636	12 5/8"	30 5/8"	13 13/16"	31 13/16"	12 1/4"	30 1/4"	11 1/8"	29 1/8"	12 5/8"	30 5/8"
WPG2136	15 5/8"	30 5/8"	16 13/16"	31 13/16"	15 1/4"	30 1/4"	14 1/8"	29 1/8"	15 5/8"	30 5/8"
WPG2436	18 5/8"	30 5/8"	19 13/16"	31 13/16"	18 1/4"	30 1/4"	17 1/8"	29 1/8"	18 5/8"	30 5/8"
WPG1530	9 5/8"	24 5/8"	10 13/16"	25 13/16"	9 1/4"	24 1/4"	8 1/8"	23 1/8"	9 5/8"	24 5/8"
WPG3030	9 5/8"	24 5/8"	10 13/16"	25 13/16"	9 1/4"	24 1/4"	8 1/8"	23 1/8"	9 5/8"	24 5/8"
WPG1830	12 5/8"	24 5/8"	13 13/16"	25 13/16"	12 1/4"	24 1/4"	11 1/8"	23 1/8"	12 5/8"	24 5/8"
WPG3630	12 5/8"	24 5/8"	13 13/16"	25 13/16"	12 1/4"	24 1/4"	11 1/8"	23 1/8"	12 5/8"	24 5/8"
WPG2130	15 5/8"	24 5/8"	16 13/16"	25 13/16"	15 1/4"	24 1/4"	14 1/8"	23 1/8"	15 5/8"	24 5/8"
WPG2430	18 5/8"	24 5/8"	19 13/16"	25 13/16"	18 1/4"	24 1/4"	17 1/8"	23 1/8"	18 5/8"	24 5/8"
WPG3024	9 5/8"	18 5/8"	10 13/16"	19 13/16"	9 1/4"	18 1/4"	8 1/8"	17 1/8"	9 5/8"	18 5/8"
PWPG3024	9 5/8"	18 5/8"	10 13/16"	19 13/16"	9 1/4"	18 1/4"	8 1/8"	17 1/8"	9 5/8"	18 5/8"
WPG3624	12 5/8"	18 5/8"	13 13/16"	19 13/16"	12 1/4"	18 1/4"	11 1/8"	17 1/8"	12 5/8"	18 5/8"
PWPG3624	12 5/8"	18 5/8"	13 13/16"	19 13/16"	12 1/4"	18 1/4"	11 1/8"	17 1/8"	12 5/8"	18 5/8"
DCPG2442	9 5/8"	36 5/8"	10 13/16"	37 13/16"	9 1/4"	36 1/4"	11 1/8"	35 1/8"	12 5/8"	36 5/8"
DCPG2742	9 5/8"	36 5/8"	10 13/16"	37 13/16"	9 1/4"	36 1/4"	11 1/8"	35 1/8"	12 5/8"	36 5/8"
DCPG2436	9 5/8"	30 5/8"	10 13/16"	31 13/16"	9 1/4"	30 1/4"	11 1/8"	29 1/8"	12 5/8"	30 5/8"
DCPG2736	9 5/8"	30 5/8"	10 13/16"	31 13/16"	9 1/4"	30 1/4"	11 1/8"	29 1/8"	12 5/8"	30 5/8"
DCPG2430	9 5/8"	24 5/8"	10 13/16"	25 13/16"	9 1/4"	24 1/4"	11 1/8"	23 1/8"	12 5/8"	24 5/8"

**NOTES** ✓

▶ Nantucket, Augusta, and Teagan are not available in Wall Prepped for Glass cabinets.

HARDWARE CHART				
	PRODUCT CODE	Item Description	Finish/Color	Drill Center
	H112	Knob	Black Chrome	N/A
	H167	Knob	Polished Brass Plated	N/A
	H300	Knob	Patina Black	N/A
	H302 *	Pull	Patina Black	4"
	H303	Knob	Patina Black	N/A
	H304 *	Pull	Patina Rouge	4"
	H305	Knob	Patina Rouge	N/A
	H307	Knob	Patina Rouge	N/A
	H308 *	Pull 5 1/16"	German Bronze	128mm
	H310	Round Knob 1 1/4"	German Bronze	N/A
	H311 *	Pull 5 1/16"	Antique Pewter	128mm
	H312 *	Cup Pull 2 1/2"	Antique Pewter	64mm
	H313	Round Knob 1 1/4"	Antique Pewter	N/A
	H314 *	Pull	Brushed Satin Nickel	96mm

**NOTES** ✓

- ▶ Screws included with hardware.
- ▶ Order under style #010.
- ▶ Hardware is recommended for use on all full overlay and miter door styles (except Avalon and Radford). All other door styles have a reverse bevel and hardware is not required.

★Hardware does not fit certain Nantucket, Durham, and Wentworth drawers because of small width of recessed center drawer panel.





**HARDWARE CHART**

	PRODUCT CODE	Item Description	Finish/Color	Drill Center
	<b>H315 *</b>	Pull	Brushed Satin Nickel	128mm
	<b>H316</b>	Round Knob 1 1/4"	Brushed Satin Nickel	N/A
	<b>H317</b>	Knob 1 1/4"	Polished Chrome	N/A
	<b>H318 *</b>	Pull	Flat Black	128mm
	<b>H319</b>	Large Flower Twist Knob	Pewter	N/A
	<b>H320 *</b>	Twist Wire Drop Handle	Pewter	5"
	<b>H322</b>	Knob	Nouveau White	N/A
	<b>H323</b>	Round Knob 1 1/4"	Flat Black	N/A
	<b>H332</b>	Pull	Brushed Satin Nickel	4"
	<b>H333 *</b>	Pull	Venetian Bronze	4"
	<b>H334 *</b>	Knob	Venetian Bronze	N/A
	<b>New H335</b>	Birdcage Pull	Pewter	4"
	<b>New H336</b>	Pull 5"	Venetian Bronze	128 mm
	<b>New H337</b>	Birdcage Pull	Venetian Bronze	4"

**NOTES** ✓

- ▶ Screws included with hardware.
- ▶ Order under style #010.
- ▶ Hardware is recommended for use on all full overlay and miter door styles (except Avalon and Radford). All other door styles have a reverse bevel and hardware is not required.

\*Hardware does not fit certain Nantucket, Durham, and Wentworth drawers because of small width of recessed center drawer panel.

HARDWARE CHART				
	PRODUCT CODE	Item Description	Finish/Color	Drill Center
	<b>New H338</b>	Pull	Black Chrome	4"
	<b>New H339</b>	Birdcage Knob	Venetian Bronze	N/A
	<b>New H340</b>	Knob	Venetian Bronze	N/A
	<b>New H341</b>	Maple Knob	Standard Finishes	N/A
	<b>New H342</b>	Oak Knob	Standard Finishes	N/A

**NOTES** ✓

- ▶ Screws included with hardware.
- ▶ Order under style #010.
- ▶ Hardware is recommended for use on all full overlay and miter door styles (except Avalon and Radford). All other door styles have a reverse bevel and hardware is not required.
- ★ Hardware does not fit certain Nantucket, Durham, and Wentworth drawers because of small width of recessed center drawer panel.